

# CITY OF MURRAY CONTROL MONUMENT CARD

DESIGNATION: BM D3 A  
TYPE: CONCRETE MONUMENT W/ CITY DISK  
DATE SET: JUNE 2002 QUAD: DEXTER, KY.  
HORIZONTAL DATUM: NAD-83 VERTICAL DATUM: NAVD-88  
STATE: KENTUCKY COUNTY: CALLOWAY ZONE: KY. S 1602

NORTHING: 1761851.38 FT  
EASTING: 889441.75 FT  
ELEVATION: 526.97 FT (GPS)  
LATITUDE: N 36°38'20.11298" LONGITUDE: W 088°18'35.13663"  
SCALE: CONVERGENCE:  
PLANE AZI. TO AZI. MARK:

To Reach: Located at the intersection of State Route 641 and Utterback Road.

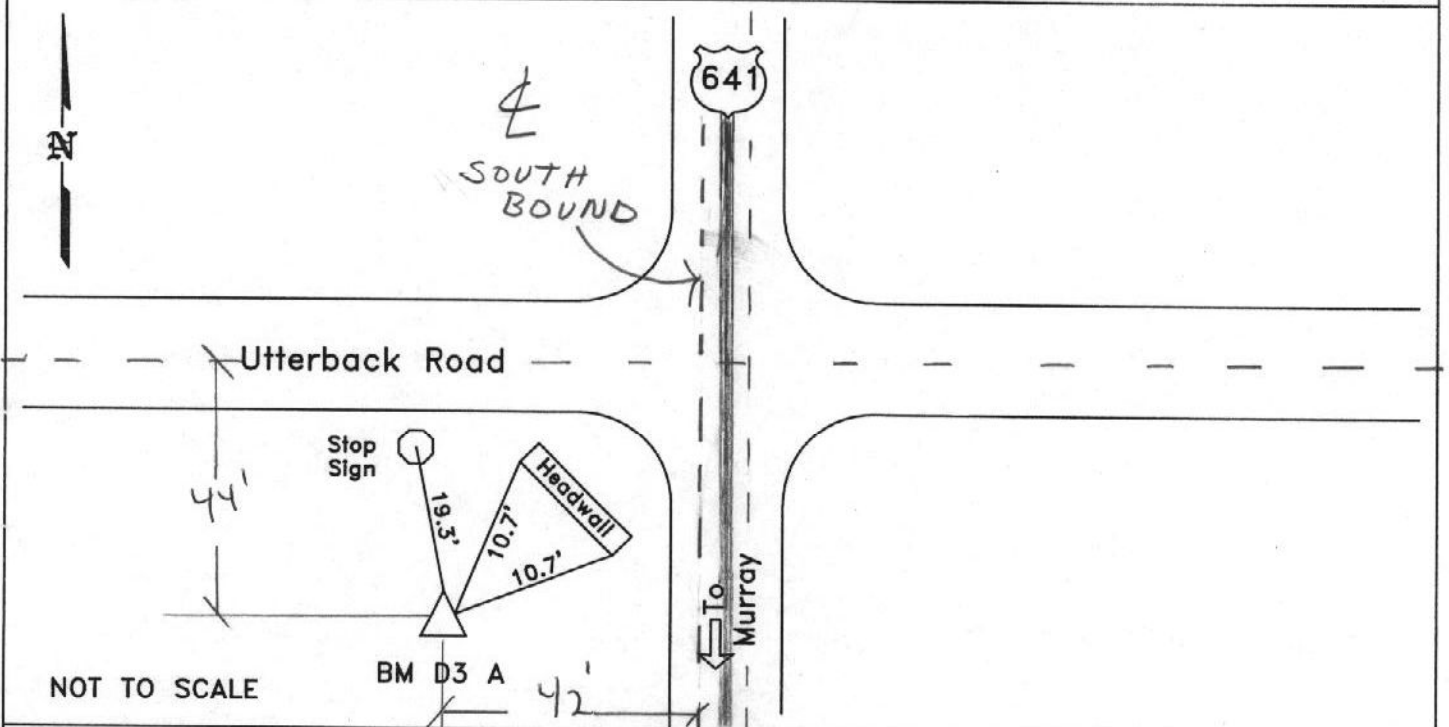

GRW Aerial Surveys, Inc.  
801 Corporate Dr. Lexington Ky. 40503  
(859)223-3999